

ITEM 1 & 4 OPTIONS	
SLIP PORT: 1 Vertical	
DOUBLE SETSCREWS	
PAINT	

ITEM 2-3 & 5-7 OPTIONS	
DOUBLE SETSCREWS	
PAINT	

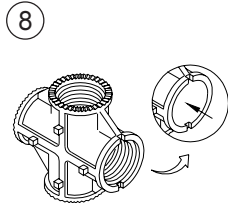

ITEM 8 OPTIONS	
SLIP PORT: 1 Vert or 2 Horiz	
DOUBLE SETSCREWS	
PAINT	

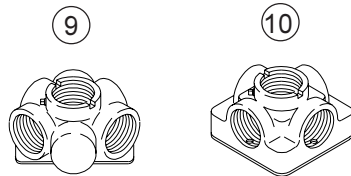

ITEM 9-10 OPTIONS	
PAINT	

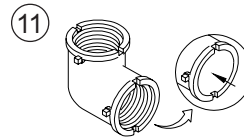

ITEMS 11 OPTIONS	
SLIP PORT: 1 Vertical	
DOUBLE SETSCREWS	
PAINT	

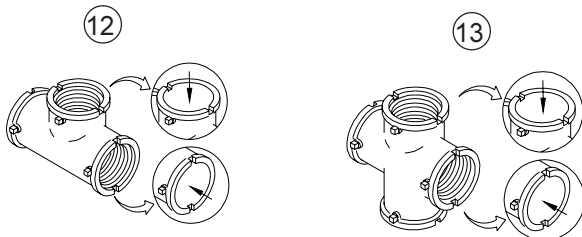

ITEM 12-13 OPTIONS	
THREADS: NPS or NPT	
SLIP PORT: 1 Vert or 2 Horiz	
DOUBLE SETSCREWS	
PAINT	

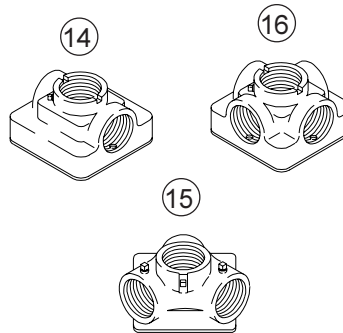

ITEM 13-15 OPTIONS	
PAINT	

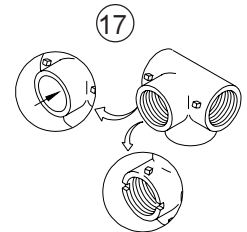

ITEMS 17 OPTIONS	
THREAD OPTIONS:	
1 1/2" NPT	
1 1/2" NPS w/ Notches	
1 1/2" NPS w/ Vert Slip	
PAINT	

ITEM	DESCRIPTION	PART NO.
	ELL, Alum	
①	Serrated	SE-0457
②	w/ Tri-Bolt Adapter	SE-0501
③	w/ Tri-Stud Adapter	SE-0514
	TEE, Alum	
④	Serrated	SE-0458
⑤	w/ Tri-Bolt Adapter	SE-0500
⑥	w/ Tri-Stud Adapter	SE-0513
⑦	Horizontal Slip	SE-0474
⑧	CROSS, Alum	SE-4038
⑨	CENTER SUPPORT, 3-Way, Alum	SE-0310
⑩	CENTER SUPPORT, 4-Way, Alum	SE-0305
⑪	ELL, Iron	SE-4091
⑫	TEE, Iron	SE-4092
⑬	CROSS, Iron	SE-4093
⑭	CENTER SUPPORT, 2-Way, Iron	SE-0495
⑮	CENTER SUPPORT, 3-Way, Iron	SE-0482
⑯	CENTER SUPPORT, 4-Way, Iron	SE-0496
⑰	SIDE OUTLET TEE, Iron	SE-0437

Notes:

- All assemblies are supplied standard with stainless steel fasteners.
- Please specify options when ordering.

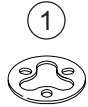

OPTIONS
ZINC 2
STAINLESS

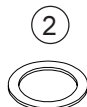

OPTIONS
ZINC 1
STAINLESS

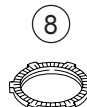
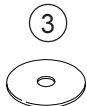

OPTIONS
W/O SETSCREWS
DOUBLE SETSCREWS



OPTIONS
W/O SETSCREWS
DOUBLE SETSCREWS
GALVANIZED



OPTIONS
COLOR: Yellow or Black



OPTIONS
COLOR: Yellow, Black, or Green

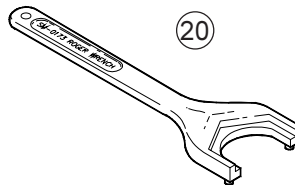
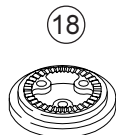

ITEM	DESCRIPTION	PART NO.
①	WASHER, Slotted	SE-0375
②	WASHER, .06" x 2.6" x 1.9"	SE-4061
③	WASHER, Single Stud, Stainless	SE-4113-SS
④	WASHER, Flat Nylon, 1-7/8" ID x 2-3/4" OD, Black	SE-0367
⑤	GASKET, Neoprene	SE-0354
⑥	GASKET, Slotted Tri-Bolt, Neoprene	AB-0278
⑦	SERRATED LOCKRING, Alum	SE-0360
⑧	SERRATED LOCKRING, Brass	SE-4029
⑨	DOUBLE SERRATED LOCKRING, Alum	SE-0451
⑩	CONDUIT LOCKNUT, Serrated, 1½"	SE-4125
⑪	CONDUIT LOCKNUT, ¾"	SE-4048
⑫	HEX NUT, 1½", Iron	SE-4017
⑬	CHECK NUT, 1½", Alum	SE-0448
⑭	CHECK NUT, 1½", Iron	SE-0316
⑮	FITTING CAP, 1½"	SE-0304
⑯	FITTING CAP, 1¼"	SE-0419
⑰	CAP, ¾" CGB Opening, Blue	AB-0271
⑱	TUBE CAP, Black	AB-0260
⑲	SIGNAL CLOSURE KIT	SE-3054
⑲	GROMMET, Neoprene w/ Diaphragm	SE-0449
⑲	ADAPTER RING, 3M, Alum	AB-0218
⑲	ICC PED HEAD SPACER, Alum	SE-0477
⑳	ROGER WRENCH w/ 10" Handle	SM-0173

Notes:

1. All assemblies are supplied standard with stainless steel fasteners.
2. Please specify options when ordering.

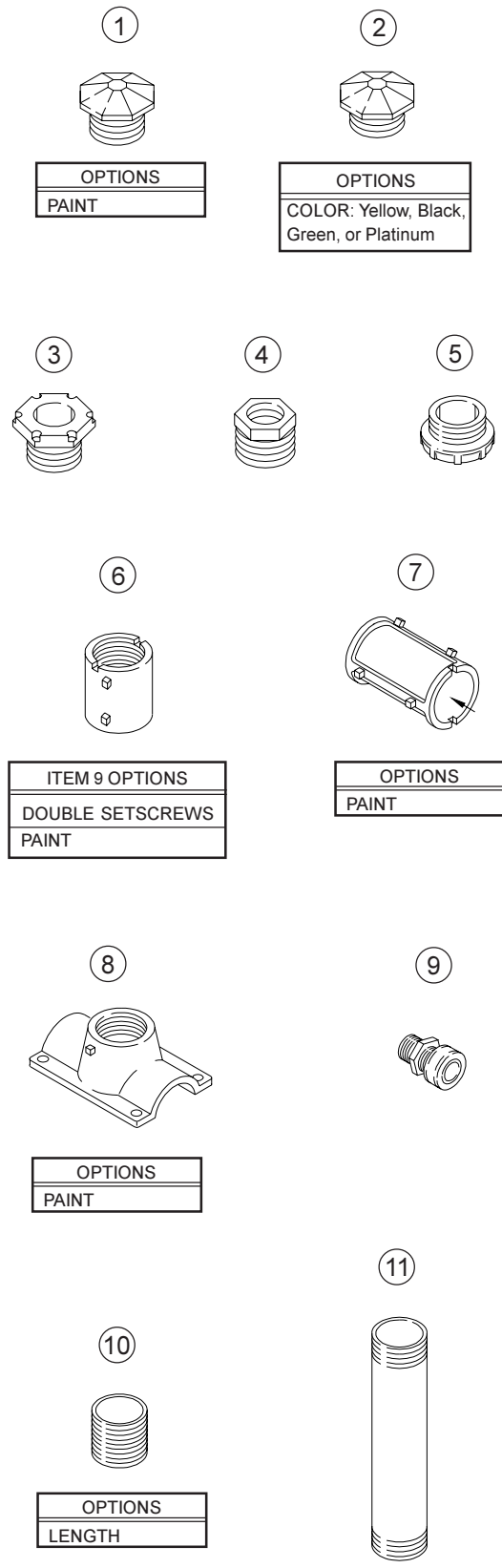

ITEM	DESCRIPTION	PART NO.
①	OCTAGONAL CLOSURE CAP, 1½" NPS x ½", Alum	SE-4088
	1½" NPS x 7/8", Alum	SE-0361
	1½" NPS x 1-3/8", Alum	SE-0483
	1½" NPS x 2", Alum	SE-0442
②	OCTAGONAL CLOSURE CAP, 7/8", Plastic	SE-0499
③	HEX NIPPLE, 1½" NPS, Alum	SE-0443
	CAST NIPPLE, 1½" NPS, Iron	SE-0435
④	REDUCER BUSHING, 1½" NPT x ¾" NPT, Iron	SE-0471
	½" NPT x 1" NPT, Iron	SE-0565
⑤	INSULATOR BUSHING, 1½" NPS	SE-4011
⑥	NOTCHED COUPLING, 1½" NPS x 2", Alum	SE-0346
	1½" NPS x 2", Steel	SE-4170
⑦	SLIP CONNECTOR, 1½" NPS, Alum	SE-0535
⑧	TUBE SADDLE, 1½", Alum	AB-0262
⑨	CGB, ¾", .55" to .65" Wire, Zinc 1	SE-4028
	¾", .625" to .75" Wire, Zinc 1	SE-0490
	1", .55" to .65" Wire, Zinc 1	SE-4216
⑩	ALL THREAD NIPPLE, 1½" NPS, Alum	SE-0309
	1½" NPS, Steel	SE-0492
	CLOSE NIPPLE, 1½" NPS x 1½" NPT, Steel	SE-4063
⑪	NIPPLE, 1½" NPS, Alum	SE-0436
	1½" NPS, Sch 80 Alum	SE-0475
	1½" NPS x 1½" NPT, Alum	SE-4214
	1½" NPS, Steel	SE-0469
	1½" NPT, Steel	SE-4200
⑫	SUPPORT TUBE, 1½" NPS, Alum	SE-0326
	2" NPS, Alum	SE-0494
	1½" NPS, Steel	SE-0491
⑬	TUBE, 1½" Alum	SE-0484

Notes:

1. All assemblies are supplied standard with stainless steel fasteners.
2. Please specify options when ordering.