

1

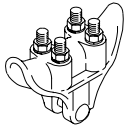

OPTIONS
J-BOLTS
STAINLESS BUSHING
STAINLESS UPGRADE

2

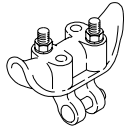

ITEM 2-3 OPTIONS
STAINLESS BUSHING
STAINLESS UPGRADE

3

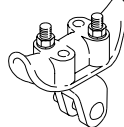

ITEM	DESCRIPTION	PART NO.
------	-------------	----------

SPAN WIRE CLAMP:

1	3/4" Wide Slot, Alum	SE-0321
	5/8" Wide Slot, Alum	SE-4077
	1/2" Wide Slot, Alum	SE-3211
2	90° w/ J-Bolts & 3/4" Slot, Alum	SE-3212
3	Universal w/ 3/4" Wide Slot & J-Bolts, Alum	SE-3217
4	Serrated w/ J-Bolts, Alum	SE-3213
5	1/2" Wide Slot, Iron	SE-0338
6	WIRE OUTLET BODY:	
	1 1/2" NPS w/ Grommet, 1/2" Wide Comb, Iron	SE-4118
	1 1/2" NPS w/ Roll Pin, 1/2" Wide Comb, Iron	SE-4103
7	Double Universal 1 1/2" NPS, 1/2" Wide Comb, Iron	SE-4155
8	3/4" Wide Comb, Alum	SE-4117
9	Multi Clevis Tri-Stud, 3/4" Wide Comb, Alum	SE-0558
10	Single Clevis Tri-Stud, 3/4" Wide Comb, Alum	SE-0531
11	Tri-Stud, 3/4" Wide Comb, Alum	SE-0545
12	Tri-Stud Adjustable w/ Grommet, Alum	SE-0523
13	Double Adjustable Tri-Stud, Alum	SE-0532
14	Double Single Clevis 1 1/2" NPS, 3/4" Wide Comb, Alum	SE-4058

4

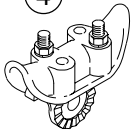

OPTIONS
STAINLESS UPGRADE

5

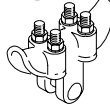

OPTIONS
J-BOLTS
STAINLESS UPGRADE

6

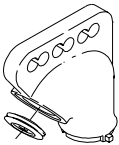

7

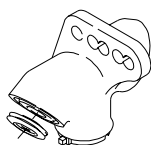

ITEMS 6-7 OPTIONS
DOUBLE SET SCREWS
PAINT

8

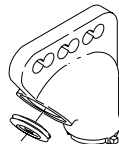

OPTIONS
DOUBLE SETSCREWS
STAINLESS BUSHING
PAINT

Notes:

- All assemblies are supplied standard with stainless steel fasteners and galvanized hardware on span wire clamps. Stainless upgrade shall include stainless steel hardware on span wire clamps.
- Specify options when ordering.

10

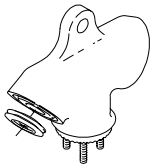

ITEM 9-11 OPTIONS
STAINLESS BUSHING

11

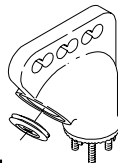

12

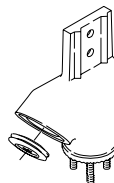

ITEM 12-13 OPTIONS
PAINT

13

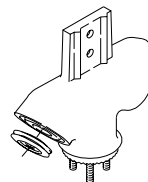

14



OPTIONS
DOUBLE SETSCREWS
STAINLESS BUSHING
STAINLESS UPGRADE

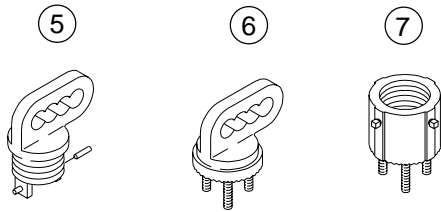
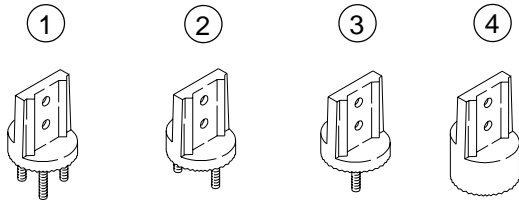

ITEM 1-7 OPTIONS
PAINT

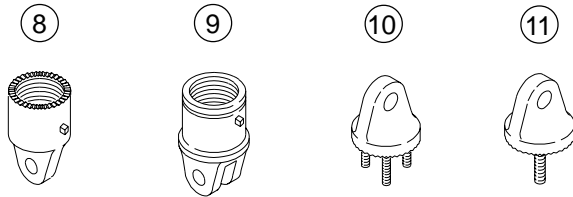

ITEM 8-11 OPTIONS
STAINLESS BUSHING
PAINT

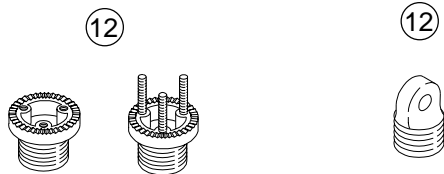

OPTIONS
TRI-BOLT or TRI-STUD

ITEM	DESCRIPTION	PART NO.
HANGER BODY:		
①	Tri-Stud, Alum	SE-0512
②	Double Stud, Alum	SE-0516
③	Tri-Stud, Alum	SE-0438
④	1 1/2" NPS, Alum	SE-0530
DISCONNECT BALANCER:		
⑤	1 1/2" NPS, 1/2" Wide Comb, Iron	SE-0380
⑥	Tri-Stud, 3/4" Wide Comb, Alum	SE-0505
⑦	TRI-STUD ADAPTER, 1 1/2" NPS, Alum	SE-0533
CLEVIS ADAPTER:		
⑧	1 1/2" NPS, 3/4" Clevis, Alum	SE-4030
⑨	1 1/2" NPS, Double, 3/4" Wide Slot, Alum	AB-0316
⑩	Tri-Stud, 3/4" Wide Clevis, Alum	SE-4031
⑪	Tri-Stud, 3/4" Wide Clevis, Alum	SE-0540
⑫	TRI-BOLT/TRI-STUD ADAPTER, 1 1/2" NPS, Alum	SE-0502
⑬	SPAN WIRE ADAPTER, 1 1/2" NPS, Brass	SE-0345

Notes:

1. All assemblies are supplied standard with stainless steel fasteners.
2. Specify options when ordering.

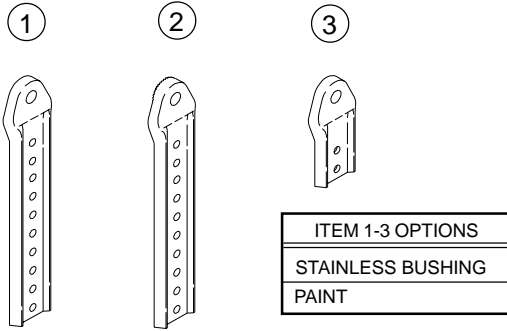

ITEM 1-3 OPTIONS	
STAINLESS BUSHING	
PAINT	

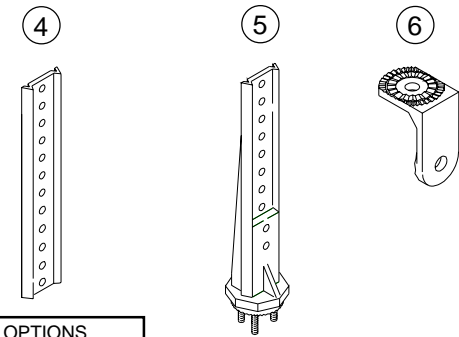

OPTIONS	
LENGTH:	
11", 19", 40", or 72"	
PAINT	

ITEM	DESCRIPTION	PART NO.
EXTENDER CONNECTOR HANGER,		
①	10-Hole, Alum	SE-0539
②	10-Hole Serrated, Alum.	SE-0543
③	2-Hole, Alum	SE-0508
④	EXTENDER, Alum	SE-0507
⑤	TRI-STUD HANGER BODY,	
	Adjustable 10-Hole, Alum	SE-0538
⑥	L-SHAPED SIGN ADAPTER, Serrated, Alum	SE-0541
⑦	SIGN HANGER, Serrated, 6" & 14" CTC, Alum	SE-0542
CAST SIGN MOUNT:		
⑧	Single, 16" CTC, Alum	SE-0537
⑨	Double, 16" CTC, Alum	SE-0556
⑩	STABILIZER BAR, 2" x 6", 2-Hole, Alum	SE-0536
⑪	STABILIZER BLOCK, 2" x 6", 2-Hole, Alum	SE-0544
TETHER PLATE:		
⑫	1-Hole, Alum	SE-0510
⑬	2-Hole, Alum	SE-0509
⑭	Slotted, Alum	SE-0515

Notes:

1. All assemblies are supplied standard with stainless steel fasteners and galvanized hardware on span wire clamps.
2. Specify options when ordering.

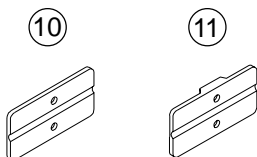
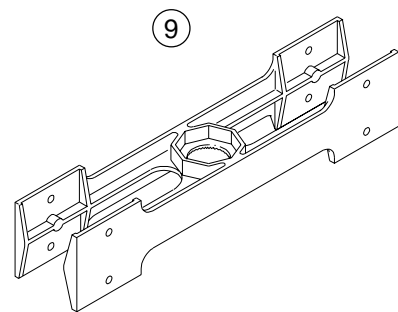
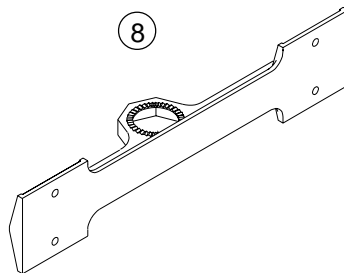
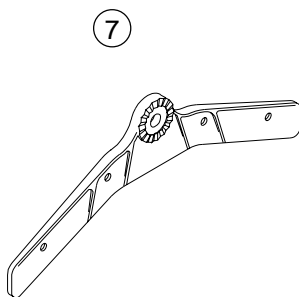

ITEM 5-11 OPTIONS	
PAINT	

