

ITEM	DESCRIPTION	PART NO.
TETHER ASSEMBLY:		
①	1½" Break-Away, Alum	SE-5121
②	Single-Stud Break-Away, Alum	SE-5058
③	Tri-Stud Break-Away, Alum	SE-5050
④	Break-Away, 1½" Pipe, Steel	SE-3055
⑤	Non-Break-Away, Alum	SE-3293
HARDWARE KIT:		
6	Single Stud, 5/16"	SE-5064
7	Tri-Stud w/o Gasket, 5/16	SE-5035

Notes:

1. All assemblies are supplied standard with stainless steel fasteners.
2. Please specify options when ordering.

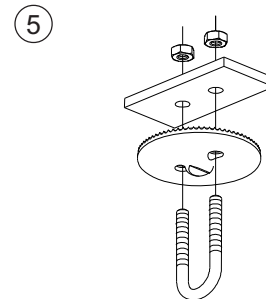
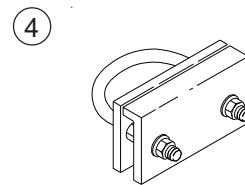
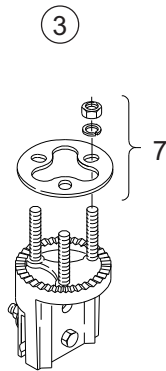
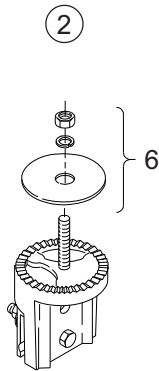
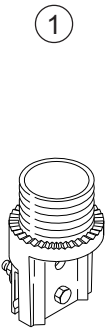

ITEM 1-3 OPTIONS
EXTENDER: 11", 19" or 72"
PAINT

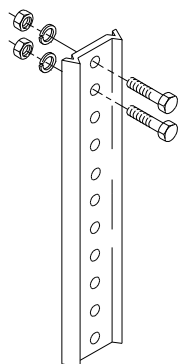

Extender
Option

ITEM 4-5 OPTIONS
PAINT