

PEDESTRIAN PUSH BUTTONS

5" x 7" Stations

①

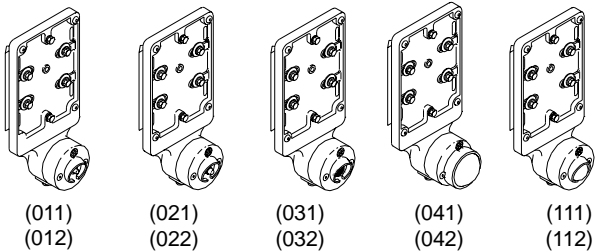
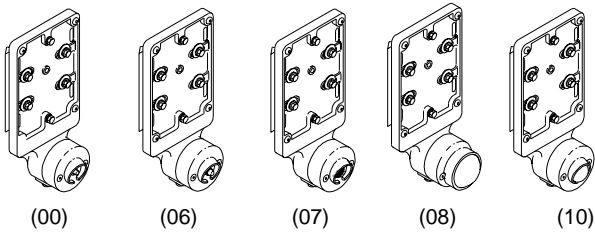

| OPTIONS | | | |
|-----------------------|------|----------------|----------------|
| | w/o | Led w/ | Led w/ |
| | Led | Circuit Module | Terminal Strip |
| Wire Leads | (00) | (011) | (012) |
| Freezeproof Boot | (06) | (021) | (022) |
| Freezeproof Diaphragm | (07) | (031) | (032) |
| 2" Mushroom Plunger | (08) | (041) | (042) |
| 1-1/8" Dome Plunger | (10) | (111) | (112) |
| PAINT | | | |

| ITEM | DESCRIPTION | PART NO. |
|------|-------------|----------|
|------|-------------|----------|

PUSH BUTTON STATION ASSY, 5" x 7" Adjustable:

| | | |
|---|---|---------|
| ① | w/ Long Life Switch | SE-2011 |
| | w/ Long Life Switch & Cable Guide | SE-2023 |
| ② | w/ Snap Action Switch | SE-2072 |
| | w/ Snap Action Switch & Cable Guide | SE-2075 |
| ③ | w/ Heavy Tension Switch w/ Boot | SE-2071 |
| | w/ Heavy Tension Switch w/ Boot & Cable Guide | SE-2074 |
| ④ | w/ Mechanical Switch w/ Ball & 2" Mushroom Plunger | SE-2115 |
| | w/ Mechanical Switch w/ Ball & 2" Mushroom Plunger & Cable Guide | SE-2116 |
| ⑤ | w/ Metal Actuator Switch | SE-2024 |
| | w/ Metal Actuator Switch & Cable Guide | SE-2025 |

Notes:

1. All assemblies are supplied standard with stainless steel fasteners.
2. For pedestrian signs refer to page 15 of this catalog section.
2. Please specify options when ordering.

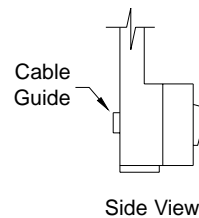

②

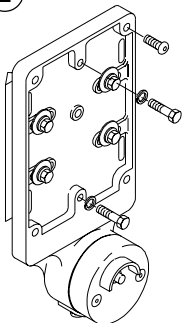

③

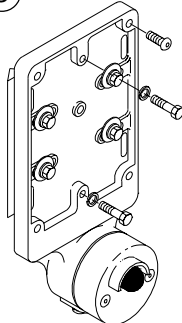

④

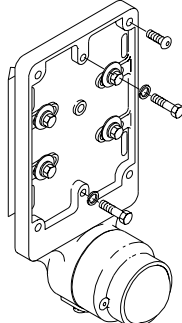

⑤

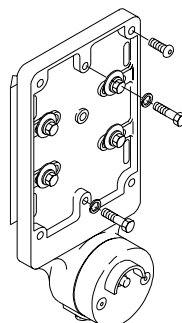

| |
|------------------|
| ITEM 2-5 OPTIONS |
| PAINT |