

SIG Aluminum Pedestrian Signal* Bulletin 1180

Features

Meets or exceeds ITE specifications.
Design provides minimum weight but maximum rigidity and strength.

HOUSING -- One piece die-cast unit with serrations in 5° increments at each end. Each housing has provisions for mounting two terminal blocks. Housings may be fastened together to make multi-section signals.

DOOR -- One piece die-cast aluminum unit equipped with stainless steel hinge pins. Two stainless steel captive eye-bolts and wing nuts permit easy access to the inside of the housing.

VISOR -- One piece formed aluminum visor is secured with stainless steel hardware. Cutaway and tunnel visors are available.

REFLECTOR -- Aluminum reflector treated with specular ALZAK® finish.

LENS -- Polycarbonate lens with completely opaque background. Glass lenses are also available.

GASKETS -- Weathertight quality of the unit is assured by separate lens and door gaskets.

LAMP SOCKET -- Gasketed, prefocused, and may be rotated for positioning the lamp filament without using tools.

POSITIVE POSITIONING -- Positive positioning and locking is achieved through the use of serrated brackets.

MOUNTING -- Completely compatible with all standard signal hardware.

**Available in 12" (300mm) only.*

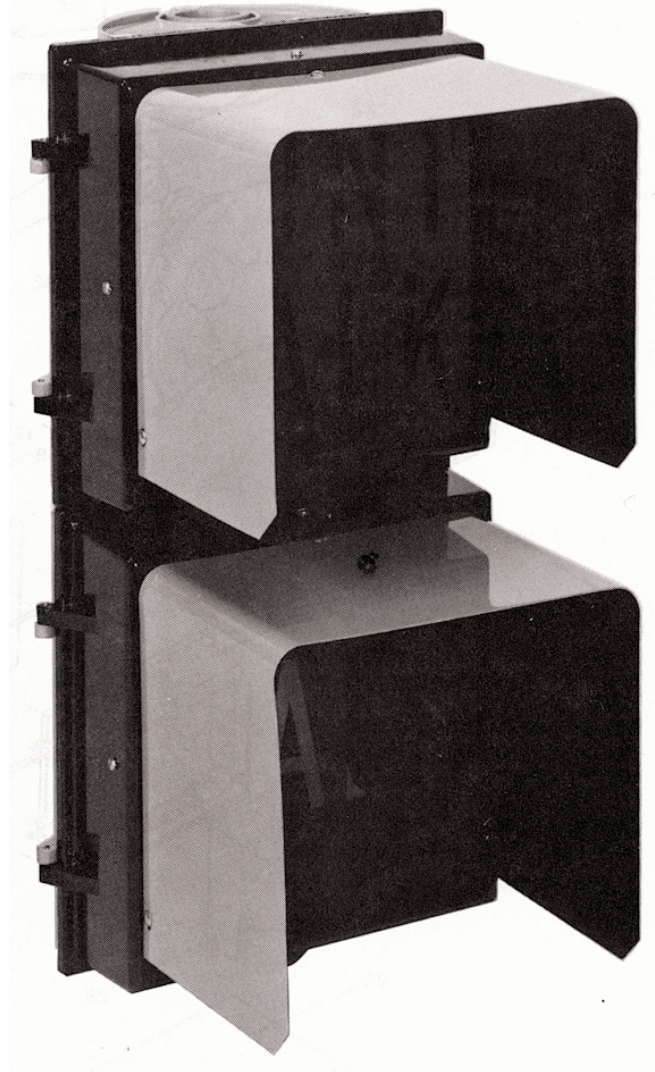

**PEDESTRIAN SIGNALS
(SIG ALUMINUM)**

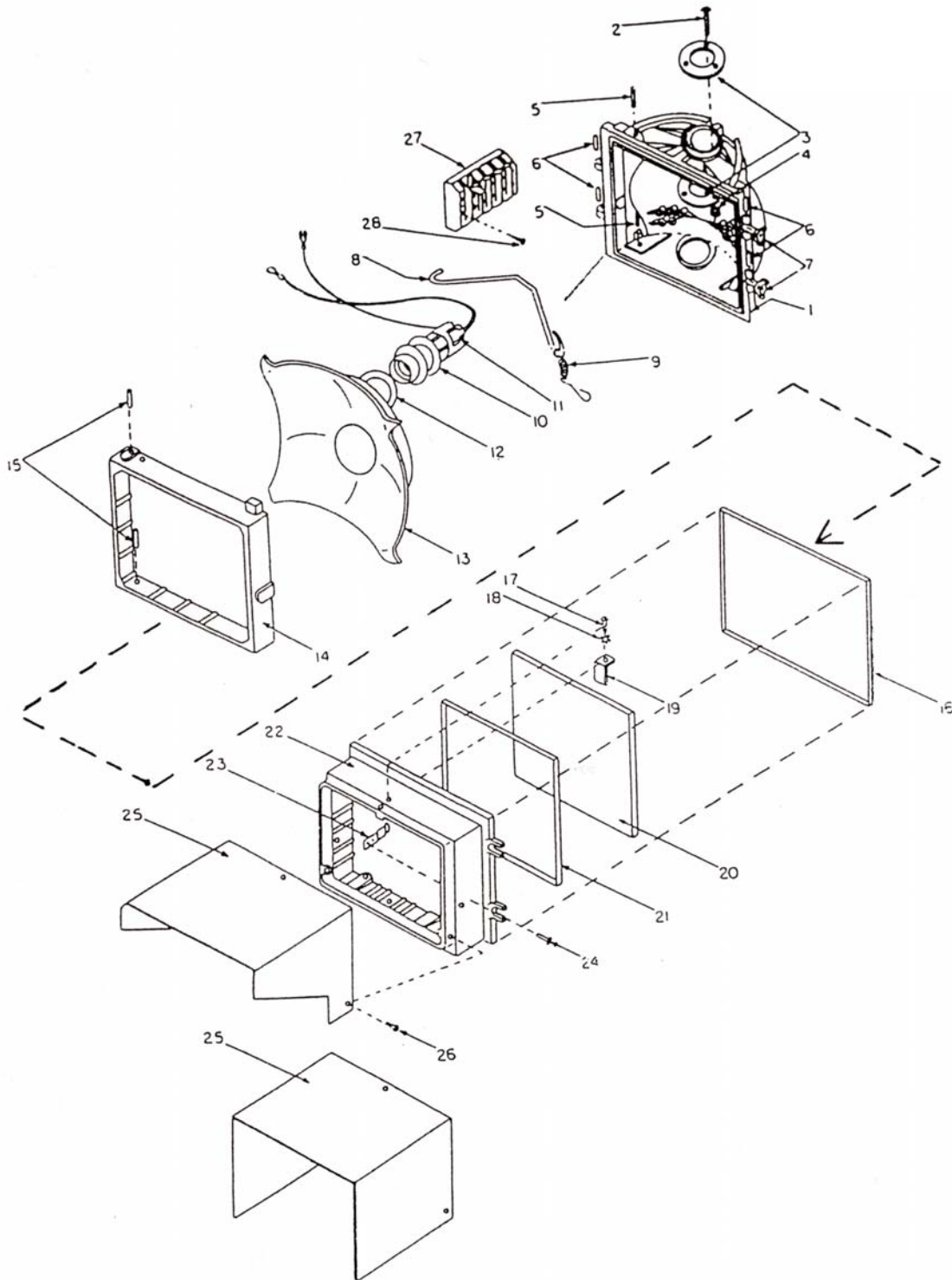

**replacement
parts
12" (300mm)
pedestrian signals**

Ref. No.	Description	Part Number
		12" (300mm)
1	Signal housing	A701821R
2	Carriage bolt (1/4 - 20 x 1 3/4")	A701101
3	Clamping washer	A844258
4	Hex nut (1/4 - 20)	A143416
5	Type 2 groove pin (3/16 x 1 3/16")	A844030
6	Spiral pin, SS (3/16 x 1")	A144006
7	Wingnut -- eyebolt assy.	A844263
8	Bail wire	A146289
9	Bail spring	A844337
10	Socket with brass screw shell	A702029
11	Lead assy. w/spade lugs, red	A844252
	Lead assy. w/spade lugs, green	A844250
12	Socket gasket	A844249
13	Reflector	A143367
14	Die-cast reflector holder	A50437R
15	Groove pin (3/16 x 3/4")	A844030
16	Door gasket	A701630
17	Screw, SS	311709
18	Washer	317238
19	Lens clip	A700336
20	Lens, poly - Portland Orange (Don't Walk)	A7020621
	Lens, poly - Lunar White (Walk)	A7020611
	Lens, poly - Portland Orange (ITE Hand)	A7020622
	Lens, poly - Lunar White (ITE Man)	A7020612
	Lens, poly - Portland Orange (Canadian Hand)	A7020623
	Lens, poly - Portland Orange (Canadian Man)	A7020613
21	Lens gasket	A701630
22	Door	A50436R
23	Locking spring	A130625
24	Rivet	A700613
25	Visor, cutaway	A853243 XX
	Visor, tunnel	A853244 XX
26	Visor screw (10 - 32 x 3/8")	A146082TF
27	Terminal block, 4 pos. spade type	A182944
28	Terminal block screw, SS (6 - 32 x 3/4")	A16257312

The pedestrian signal is composed of two die-cast Aluminum body sections containing the optical unit, lens, door and visor. It meets or exceeds ITE Specifications.

All legends are clearly visible and definable for any Width street with ample safety factor. Letters are 4 1/2" High with 7/16" stroke for 12" signal.

All the flexibility and choice of standard mounting Hardware for traffic signals are applicable.

NOTE: VISOR COLOR

XX	Color
10	Medium Green
11	Dark Green
12	Yellow
13	Gloss Black
14	Flat Black

TUNNEL VISOR

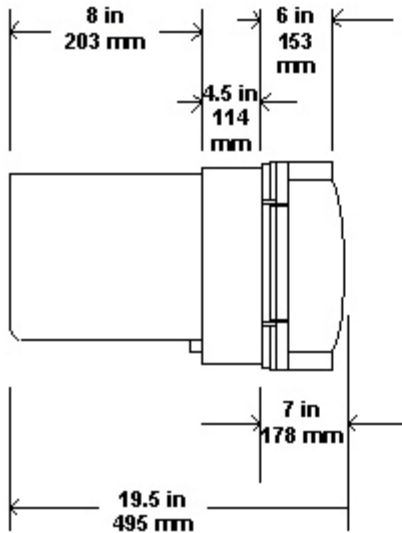

CUT AWAY VISOR

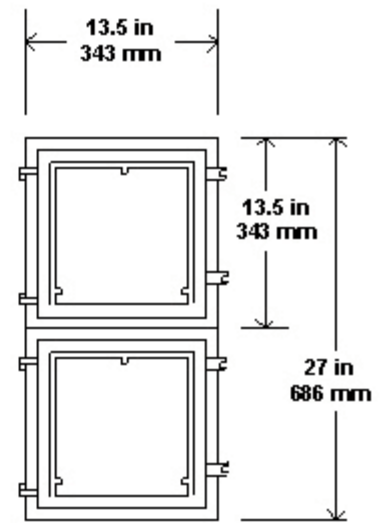
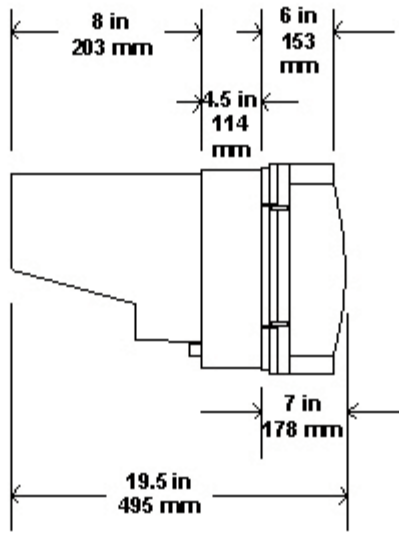

Weights	12" (300 mm)
Single section with visor (approx.)	14 lbs. (6.35 kg)
Housing	5 lbs. 6.3 oz. (2.45 kg)
Door	4 lbs. 0.4 oz. (1.83 kg)